



SPECIFICATIONS

CONTACT RATING: Q: 500mA @120 VAC or 28 VDC
 ELECTRICAL LIFE: 30,000 make-and-break cycles at full load
 CONTACT RESISTANCE: 20 mΩ max. initial @2-4 VDC, 100 mA
 INSULATION RESISTANCE: 1,000 MΩ min.
 DIELECTRIC STRENGTH: 500 V RMS @ sea level.
 OPERATING TEMPERATURE: -30° C to 85° C

MATERIALS

Base - diallyl phthalate (DAP) (UL94V-0)
 Plunger - Glass filled Nylon (UL94V-0)
 Bushing - Brass, nickel plated
 CONTACT AND TERMINAL - Copper alloy , silver plated

How do you build the switches you need!!

(A) **T** **S** - **3** **1** - **Z** - **R** - **E** - **2**

Switch Type		Terminal	Contact material	Terminal seal		Plunger color	
TS-31	SPST short	Z	Q silver plated	(none)	none seal	1	White
TS-32	SPST long	C	R gold plated	E	terminal seal	2	Black
			G Gold over silver			3	White

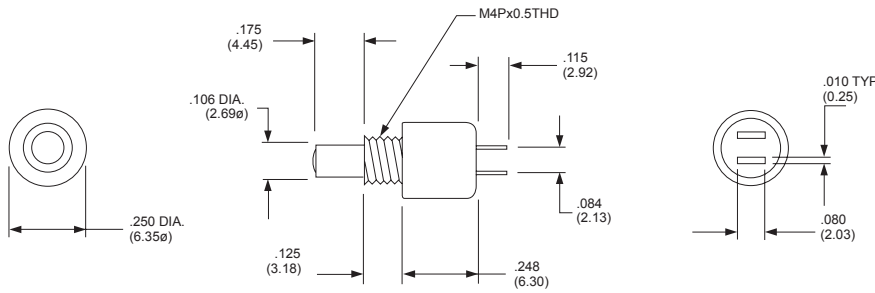

TS-31-ZR-E-2

MODEL NO.	SWITCH FUNCTION	
	POS. 1	POS. 2
TS-31	OFF	MOM.

Schematic:

N.O.
 Total Travel: .040 (1.02) typ.
 Actuation Force: 5 OZ. (140g) typ.

MOM = Momentary

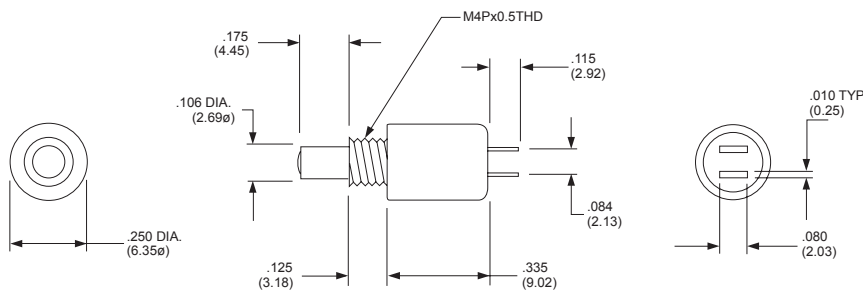

TS-32-ZR-E-2

MODEL NO.	SWITCH FUNCTION	
	POS. 1	POS. 2
TS-32	OFF	MOM.

Schematic:

N.O. w/Overtravel
 Total Travel: .106 (2.69) typ. □
 Overtravel: .024 (0.61) typ.
 Actuation Force: 6.25 OZ. (177g) typ.

MOM = Momentary

TERMINAL OPTION

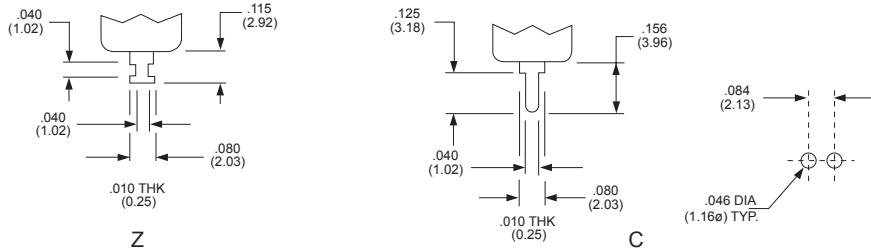

TERMINAL SEAL OPTION

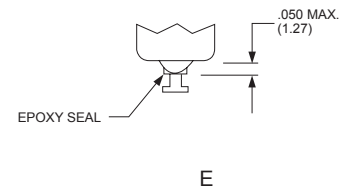

CONTACT MATERIAL OPTIONS

CODE	CONTACT MATERIAL	TERMINAL MATERIAL	RATING
Q	Silver plated	Silver plated	500mA @ 120 V AC or V DC
R	Gold plated over nickel plated	Gold plated over nickel plated	0.4VA MAX @ 20V AC or DC MAX
G	Gold plated over silver plated	Gold plated over silver plated	0.4 VA MAX @ 20 V AC or DC MAX or 500mA @ 120 V AC or 28 V DC