

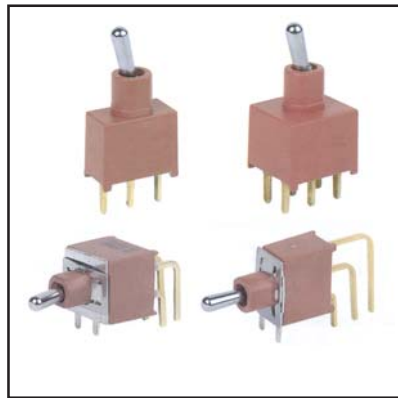

T9000E Series

Sealed Sub-Miniature Seal Toggle Switches



SPECIFICATIONS

CONTACT RATING: R 0.4VA max @20 VAC or DC
ELECTRICAL LIFE: 30,000 make-and-break cycles at full load
CONTACT RESISTANCE: 20 milliohms max. initial @2-4 VDC,100mA
INSULATION RESISTANCE: 1,000 MΩ min.
DIELECTRIC STRENGTH: 1,000 V RMS min. @ sea level.
OPERATING TEMPERATURE: -30° C to 85° C
ESD Resistant Option: P2 insulating actuator only:9,000 VDC min. @ sea level,actuator to terminals.
DEGREE OF PROTECTION : IP67
OPERATING TEMPERATURE: -30 C to 85 C

MATERIALS

CASE & BUSHING: Glass filled nylon 4/6, flame retardant heat stabilized (UL94V-0)
ACTUATOR: Brass, chrome plated with internal o-ring seal - standard
 P2 anti-static actuator: Nylon 6/6, black std(UL 94V-0)
SWITCH SUPPORT: Brass or Steel, Tin plated
CONTACT AND TERMINAL: Silver or gold plated copper alloy
TERMINAL SEAL: Epoxy

A
18

Build the switches you need!!

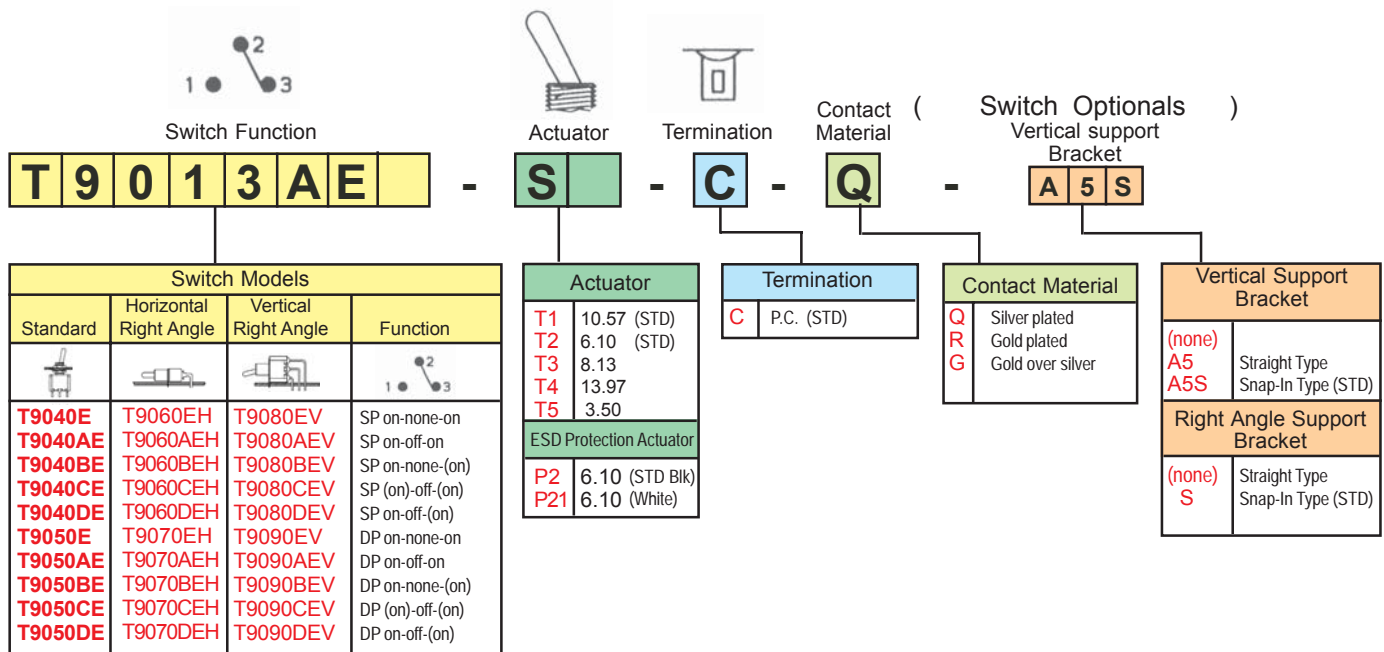

Switch Function - -

A
19

SPDT



Model No.	Switching Position		
T9040E	ON	NONE	ON
T9040AE	ON	OFF	ON
T9040BE	ON	NONE	(ON)
T9040CE	(ON)	OFF	(ON)
T9040DE	ON	OFF	(ON)
Term. Comm.	2-3	OPEN	2-1

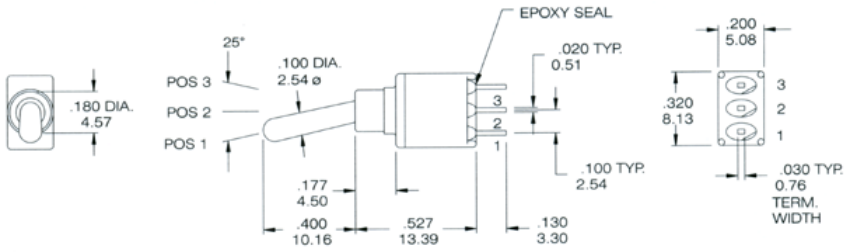

T9040E-T1CQ

DPDT



Model No.	Switching Position		
T9050E	ON	NONE	ON
T9050AE	ON	OFF	ON
T9050BE	ON	NONE	(ON)
T9050CE	(ON)	OFF	(ON)
T9050DE	ON	OFF	(ON)
Term. Comm.	2-3, 5-6	OPEN	2-1, 5-4

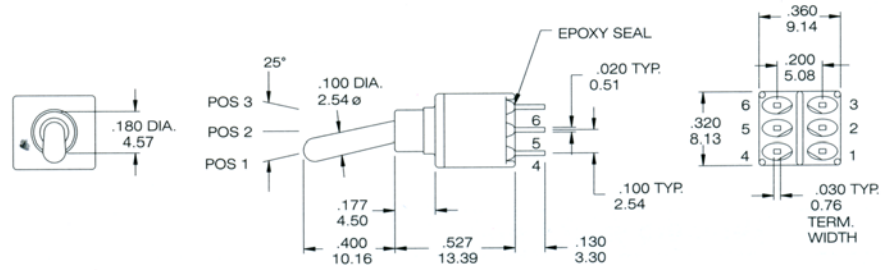

T9050E-T1CQ

HORIZONTAL RIGHT ANGLE

SPDT



Model No.	Switching Position		
T9060EH	ON	NONE	ON
T9060AEH	ON	OFF	ON
T9060BEH	ON	NONE	(ON)
T9060CEH	(ON)	OFF	(ON)
T9060DEH	ON	OFF	(ON)
Term. Comm.	2-3	OPEN	2-1

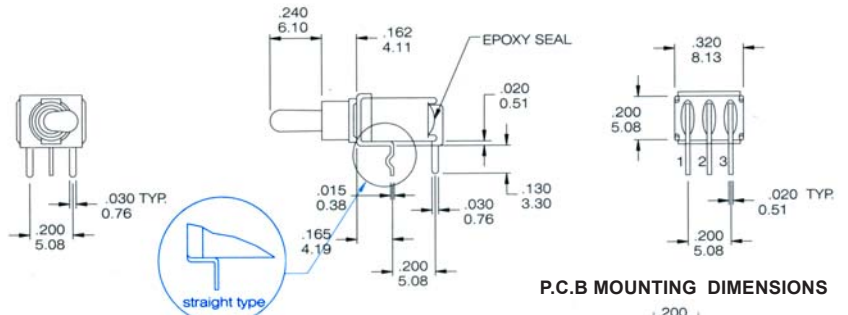

T9060E-T2CQ-S / T9060E-T2CQ

P.C.B MOUNTING DIMENSIONS

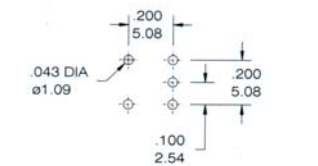

DPDT



Model No.	Switching Position		
T9070EH	ON	NONE	ON
T9070AEH	ON	OFF	ON
T9070BEH	ON	NONE	(ON)
T9070CEH	(ON)	OFF	(ON)
T9070DEH	ON	OFF	(ON)
Term. Comm.	2-3, 5-6	OPEN	2-1, 5-4

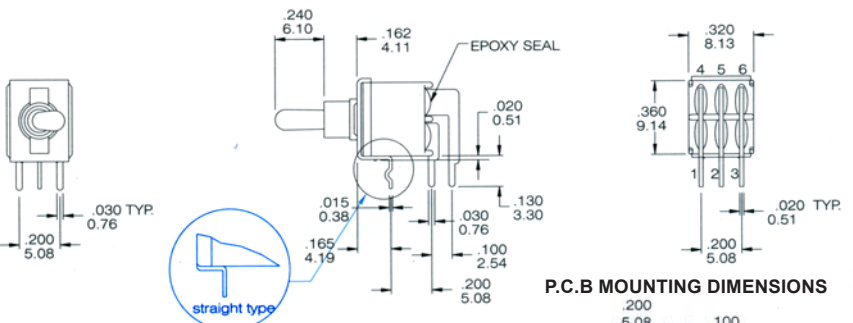

T9070E-T2CQ-S / T9070E-T2CQ

P.C.B MOUNTING DIMENSIONS

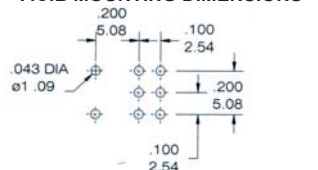

Switch Function - -

A
20

VERTICAL RIGHT ANGLE

SPDT



Model No.	Switching Position		
T9080EV	ON	NONE	ON
T9080AEV	ON	OFF	ON
T9080BEV	ON	NONE	(ON)
T9080CEV	(ON)	OFF	(ON)
T9080DEV	ON	OFF	(ON)
Term. Comm.	2-3	OPEN	2-1

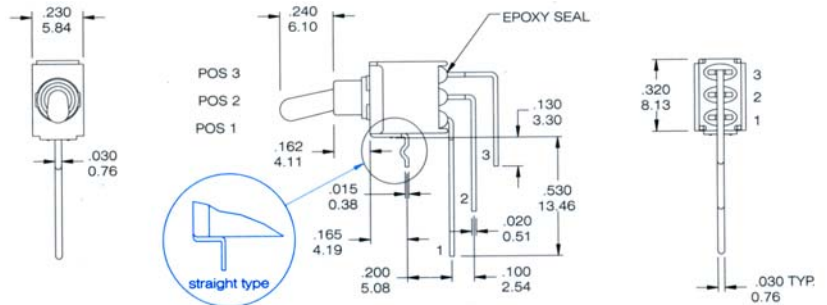

P.C.B MOUNTING DIMENSIONS

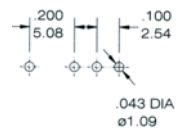

T9080E-T2CQ-S / T9080E-T2CQ

DPDT



Model No.	Switching Position		
T9090EV	ON	NONE	ON
T9090AEV	ON	OFF	ON
T9090BEV	ON	NONE	(ON)
T9090CEV	(ON)	OFF	(ON)
T9090DEV	ON	OFF	(ON)
Term. Comm.	2-3	OPEN	2-1

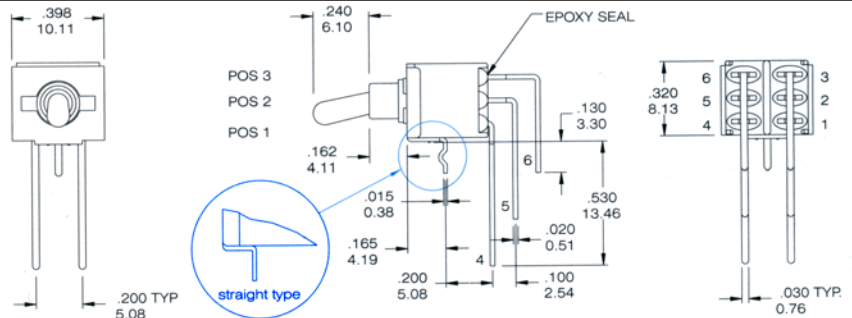

P.C.B MOUNTING DIMENSIONS

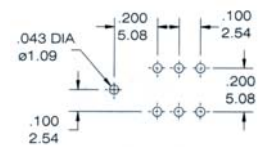

T9090E-T2CQ-S / T9090E-T2CQ

Actuator - -

Actuator Option

T1 (STD)

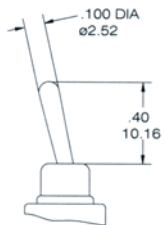

T2 (STD)

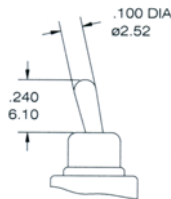

T3

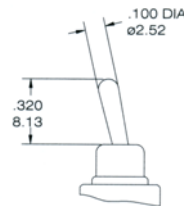

P2 Plastic Actuator (STD)

P21 Plastic Actuator

ESD protection actuator
Material Nylon 4/6 (UL 94V-0), black std.
Static resistance :9,000V DC min.
@sea level , actuator to terminals

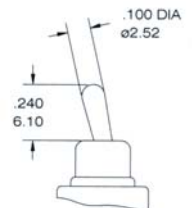

T4

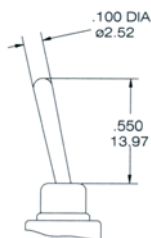

T5

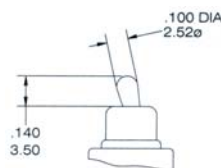

Code	Description
P2	Black (std)
P21	White

Terminal

A
21

Bushing Dimension

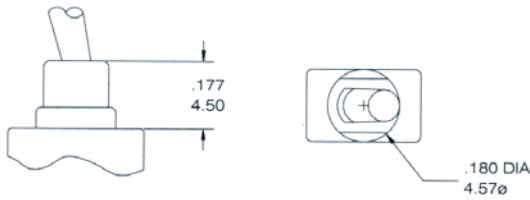

Terminal Dimension

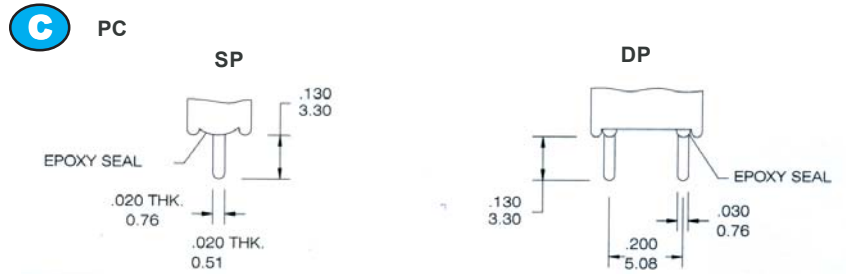

Contact Material

CONTACT MATERIAL OPTIONS

CODE	CONTACT MATERIAL	TERMINAL MATERIAL	RATING	
Q	Silver plated	Silver plated	Power	5 A@120V AC or 28 V DC; 2 A@250 VAC
R	Gold plated over nickel plated	Gold plated over nickel plated	Low Level / Dry Circuit	0.4VA MAX @ 20 V AC or DC MAX
G	Gold plated over silver plated	Gold plated over silver plated	Low Level / Dry Circuit or Power	0.4 VAMAX@20 VAC or DCMAX or 5A@120VAC or 28 V DC; 2A@250 VAC

Option: Other contact / terminal plating is available.

Contact Material

VERTICAL SUPPORT BRACKET OPTION

Only for Straight PC Type Termination (Use with option iCi terminal)

A5 - A5S

A5S
Snap-In
Type (std)

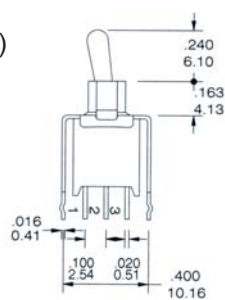

A5
Straight
Type

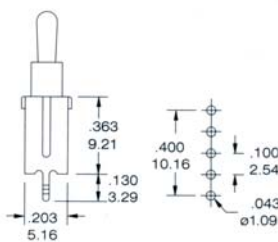
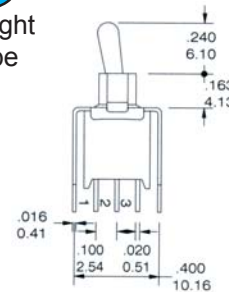

T9040 - T1CQ - A5S

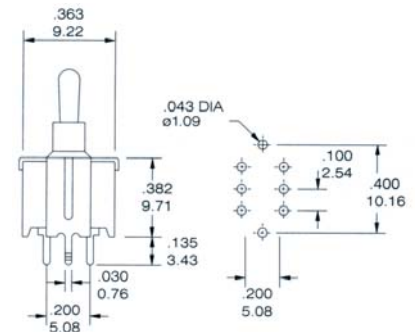

T9050 - T1CQ - A5S