

### SPECIFICATIONS

CONTACT RATING: Q: 3A @120 VAC or 28 VDC ( Q: terminal option)  
 ELECTRICAL LIFE: 30,000 make-and-break cycles at full load  
 CONTACT RESISTANCE: 20 mΩmax. initial @2-4 VDC, 100 mA  
 INSULATION RESISTANCE: 1,000 MΩmin.  
 DIELECTRIC STRENGTH: 1,500 V RMS @ sea level.  
 OPERATING TEMPERATURE: -30° C to 85° C

### MATERIALS

CASE - diallyl phthalate ( DAP )(UL94V-0)  
 ACTUATOR- Nylon , black standard  
 BUSHING - Brass , nickel plated  
 HOUSING - Stainless Steel  
 CONTACT AND TERMINAL - Copper alloy  
 SWITCH SUPPORT - Brass , tin-lead

**How do you build the switches you need!!**

The RS-4 / RS-5 , please see the (A) ;

The RS-6/RS-7/RS-8/RS-9, please see the (B)

(A) R S - 4 - R 1 - 2 - C Q - E - A 5 S

Switches Function		Actuator		Actuator Color		Termination		Epoxy seal		Vertical support Bracket	
RS-4	SP on-none-on	R1	7.62 width	1	white	B	solder lug	(none)	none seal	(none)	straight type snap-in type
RS-4B	SP on-none-(on)	R2	5.84 width	2	Black	C	P.C	E	epoxy seal	A5	
RS-4A	SP on-off-on			3	Red	D	wire wrap			A5S	
RS-4H	SP (on)-off-(on)			The other color is available for special inquires		Contact Materia					
RS-4I	SP on-off-(on)					Q	silver plated				
RS-5	DP on-none-on					R	gold plated				
RS-5B	DP on-none-(on)					G	gold over silver				
RS-5A	DP on-off-on					K	gold / tin-lead				
RS-5H	DP (on)-off-(on)										
RS-5I	DP on-off-(on)										

(B) R S - 6 - R 2 - 2 - Q - E - S

Horizon Right Angle	Vertical Right Angle	Switches Function	Actuator		Contact Materia		Epoxy seal		Support Bracket	
RS-6	RS-8	SP on-none-on	R1	7.62 width	Q	silver plated	(none)	none seal	(none)	std. straight snap-in type
RS-6B	RS-8B	SP on-none-(on)	R2	5.84 width	R	gold plated	E	epoxy seal	S	
RS-6A	RS-8A	SP on-off-on	Actuator Colo		K	gold over silver				
RS-6H	RS-8H	SP (on)-off-(on)	1	white		gold / tin-lead				
RS-6I	RS-8I	SP on-off-(on)	2	Black						
RS-7	RS-9	DP on-none-on	3	Red						
RS-7B	RS-9B	DP on-none-(on)	The other color is available for special inquires							
RS-7A	RS-9A	DP on-off-on								
RS-7H	RS-9H	DP (on)-off-(on)								
RS-7I	RS-9I	DP on-off-(on)								

### SPDT



Model No.	Switching position		
RS-4	ON	none	ON
RS-4A	ON	OFF	ON
RS-4B	ON	None (ON)	
RS-4H	(ON)	OFF (ON)	(ON)
RS-4I	ON	OFF (ON)	
Term. Comm.	2-3	open	2-1

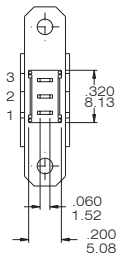
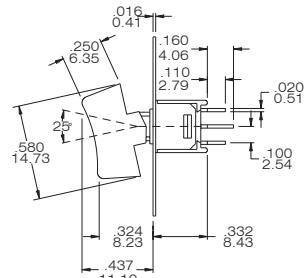
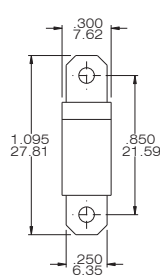

RS-4 - R1-2-BQ

### DPDT



Model No.	Switching position		
RS-5	ON	none	ON
RS-5-A	ON	OFF	ON
RS-5B	ON	None (ON)	
RS-5H	(ON)	OFF (ON)	(ON)
RS-5I	ON	OFF (ON)	
Term. Comm.	2-3,5-6	open	2-1,5-4

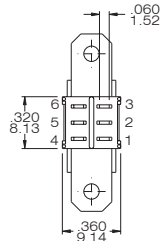
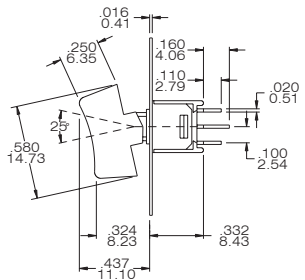
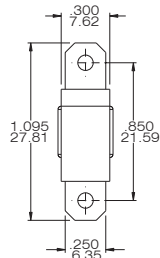

RS-5 - R1-2-BQ

### SPDT



Model No.	Switching position		
RS-6	ON	none	ON
RS-6A	ON	OFF	ON
RS-6B	ON	None (ON)	
RS-6H	(ON)	OFF (ON)	(ON)
RS-6I	ON	OFF (ON)	
Term. Comm.	2-3	open	2-1

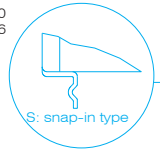
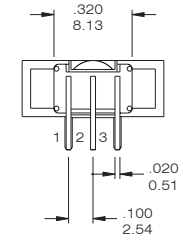
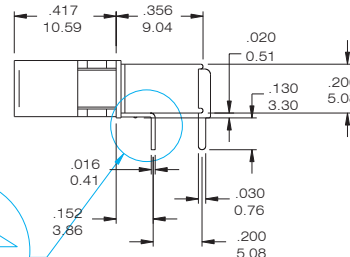
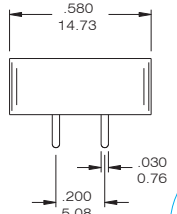

RS-6 - R2-2-Q / RS-6-R2-2-Q-S

### DPDT



Model No.	Switching position		
RS-7	ON	none	ON
RS-7A	ON	OFF	ON
RS-7B	ON	None (ON)	
RS-7H	(ON)	OFF (ON)	(ON)
RS-7I	ON	OFF (ON)	
Term. Comm.	2-3,5-6	open	2-1,5-4

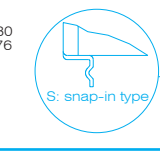
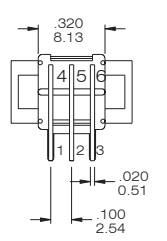
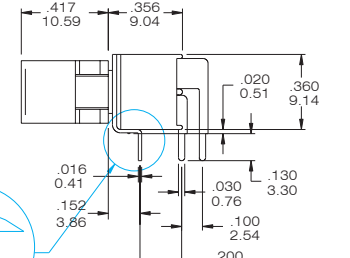
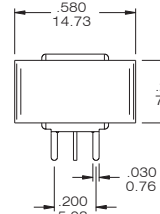

RS-7 - R1-2-Q / RS-7-R1-2-Q-S

### SPDT



Model No.	Switching position		
RS-8	ON	none	ON
RS-8A	ON	OFF	ON
RS-8B	ON	None (ON)	
RS-8H	(ON)	OFF (ON)	(ON)
RS-8I	ON	OFF (ON)	
Term. Comm.	2-3	open	2-1

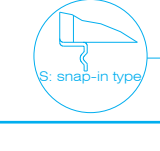
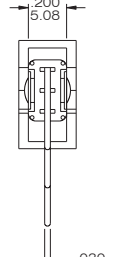
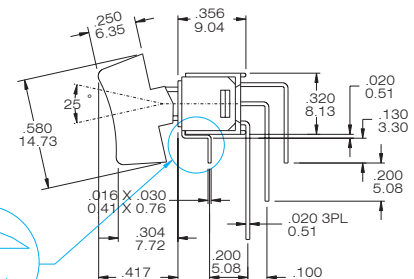
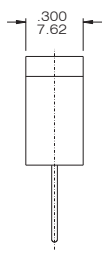

RS-8 - R1-2-Q / RS-8-R1-2-Q-S

### DPDT



Model No.	Switching position		
RS-9	ON	none	ON
RS-9A	ON	OFF	ON
RS-9B	ON	None (ON)	
RS-9H	(ON)	OFF (ON)	(ON)
RS-9I	ON	OFF (ON)	
Term. Comm.	2-3,5-6	open	2-1,5-4

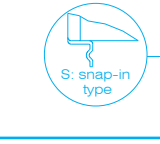
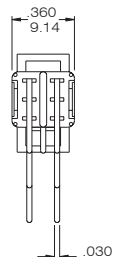
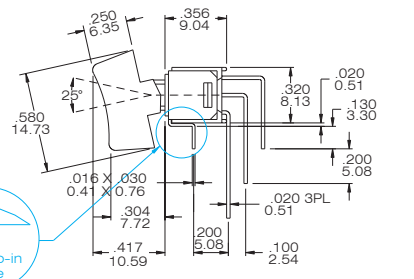
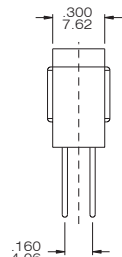

RS-9 - R1-2-Q / RS-9-R1-2-Q-S

### Actuator Option

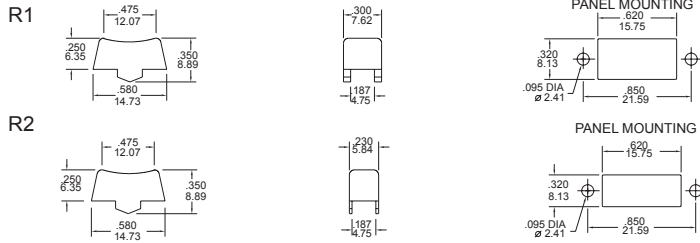

### Actuator Color Option

Code	Color
1	White
2	Black(std.)
3	Red

Other colors. custom actuator marking available consult factory.

### TERMINAL OPTION (ONLY FOR THE RS-4/RS-5)

#### B Solder Lug(STD)

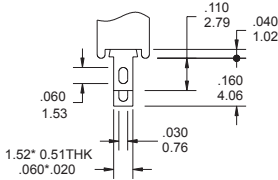

#### C PRINTED CIRCUIT

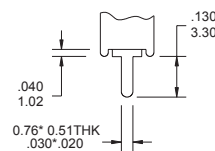

#### D Wire Wrap

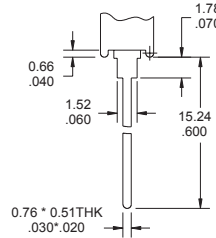

#### DPDT

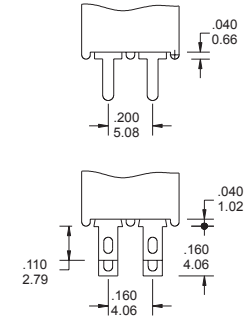

### TERMINAL OPTION (ONLY FOR THE RS-4/RS-5)

CODE	CONTACT MATERIAL	TERMINAL MATERIAL	RATING
Q	Silver plated	Silver plated	3 A @ 120V AC or 28 V DC; 1.5 A @ 250 VAC
R	Gold plated over nickel plated	Gold plated over nickel plated	0.4VA MAX @ 20 V AC or DC MAX
G	Gold plated over silver plated	Gold plated over silver plated	0.4 VA MAX @ 20 V AC or DC MAX or 3 A @ 120V AC or 28 V DC; 1.5 A @ 250 VAC
K	Gold plated over nickel plated	Tin-lead over nickel plated	0.4VA MAX @ 20 V AC or DC MAX

\* THE K option is only for some special item. Please inquiry first when you need the "K" option

### P.C.B MOUNTING DIMENSION

#### RS-4 (PC terminal)

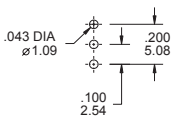

#### RS-6

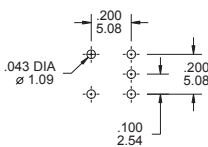

#### RS-8

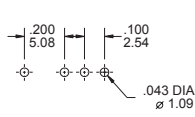

#### RS-5(PC terminal)

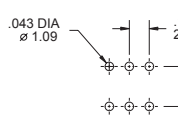

#### RS-7

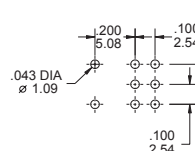

#### RS-9

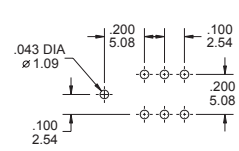

### VERTICAL SUPPORT BRACKET OPTION

only for the TS-4/TS-5 . If you need the vertical support support bracket , please build the terminal option is "C" code

#### A5/ A5S

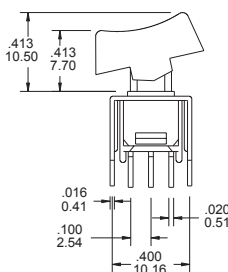

A5 (STD.)

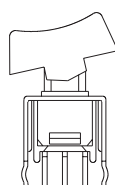

A5S (Snap-in)

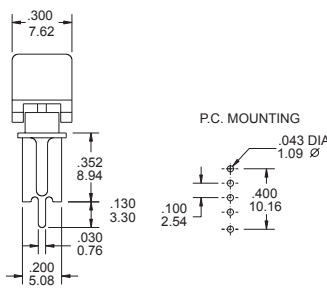

RS-4-R1-2-CQ-A5

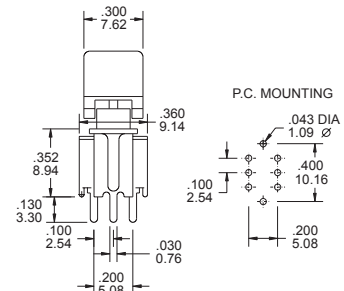

RS-5-R1-2-CQ-A5