

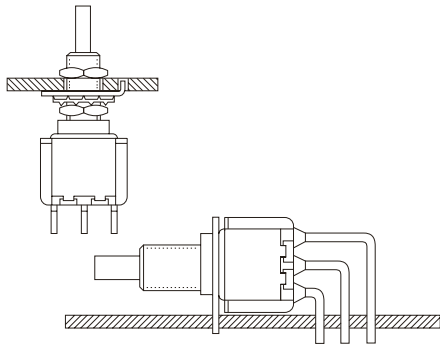

P80-P Series

Snap Acting Momentary Pushbutton Switches



SPECIFICATIONS

CONTACT RATING: 1A @120 VAC or 28 VDC
ELECTRICAL LIFE: 50,000 make-and-break cycles at full load
CONTACT RESISTANCE: 20 mOhm max. initial @2-4 VDC, 100 mA
INSULATION RESISTANCE: 1,000 MOhm min.
DIELECTRIC STRENGTH: 1,000 V RMS @ sea level.
OPERATING TEMPERATURE: -30 deg. C to 85 deg. C

MATERIALS

CASE - diallyl phthalate (DAP)
PLUNGER - Glass filled nylon or glass filled polyster (UL94V-0)
BUSHING - Brass , nickel plated
HOUSING - Stainless Steel
CONTACT AND TERMINAL - Brass, silver plated

How do you build the switches you need!!

The straight type, please see the (A);

The right angle P.C terminals, please see the (B)

(A) P 8 7 0 1 - C V 1 - 2 - C R - E - S 2 0

Switches Function		Cap		Cap color	Bushing			Epoxy seal		Vertical support Bracket	
P8701	SPDT on-mon	none	(none)	1	(None)	(Std.) Thd /key-way	7.52	(none)	none seal	(none)	
P8702	DPDT on-mon	CV	5.08	2	N	Non-thd /key-way	7.52	E	epoxy seal	S20	11.68
		CV1	7.87	3	E	Thd. Key-way	8.89			V20	snap-in 11.68
		CV2	9.53	4	M	Non-thd/key-way	8.89				
		CV4	dress nut	5	F8	Thd. / Flat	7.52				
		F22A	With frame	6	N8	Non-thd / Flat	7.52				
				7							
				8							
				9							
Termination											
					B	solder lug					
					C	P.C 1.27width					
					D1	wire wrap 19.05					
Contact Material											
					Q	silver plated					
					R	gold plated					
					G	gold over silver					

(B) P 8 7 0 1 - A 4 - C V 1 - 2 - R - E - S

Switches Function		Right Angle		Cap		Cap color	Bushing			Contact Material	
P8701	SPDT on-mon	A4	Horizon	none	(none)	1	(None)	(Std.) non-Thd/key-way	7.52	Q	silver plated
P8702	DPDT on-mon	A5	Vertical	CV	5.08	2	F	Thd. Key-way	7.52	R	gold plated
				CV1	7.87	3	E	Thd /key-way	8.89	G	gold over silver
				CV2	9.53	4	M	Non-thd/key-way	8.89		
						5	F8	Thd. / Flat	7.52		
						6	N8	Non-thd / Flat	7.52		
						7					
						8					
						9					
Epoxy seal											
										(none)	none seal
										E	epoxy seal
Support Bracket											
										(none)	std.
										S	snap-in type

SPDT



Model No.	Switching position	
P8701	on	Mom
Term. Comm.	1-3	1-2

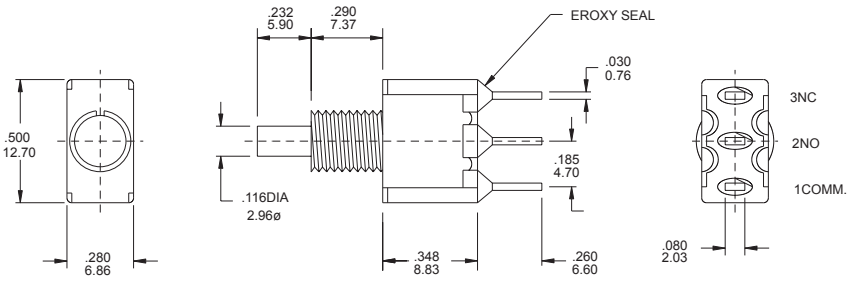
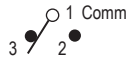

P8701-BR-E

SPDT



Model No.	Switching position	
P8701-A4	on	Mom
Term. Comm.	1-3	1-2

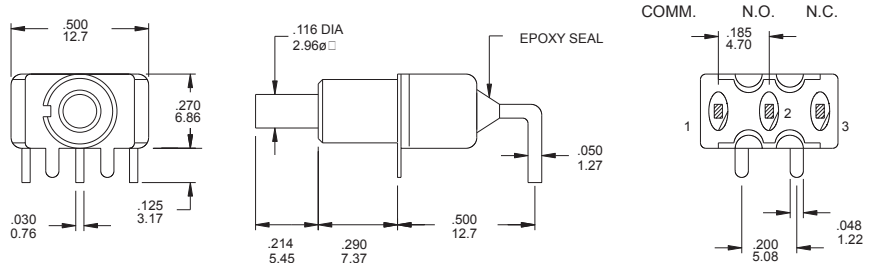

P8701-A4-R-E

SPDT

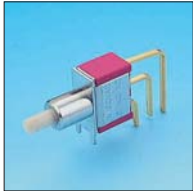

Model No.	Switching position	
P8701-A5	on	Mom
Term. Comm.	1-3	1-2

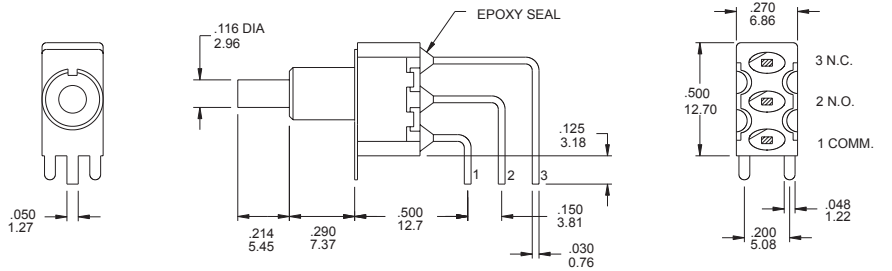
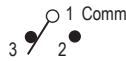

P8701-A5-R-E

DPDT



Model No.	Switching position	
P8702	on	Mom
Term. Comm.	1-3 4-6	1-2 4-5

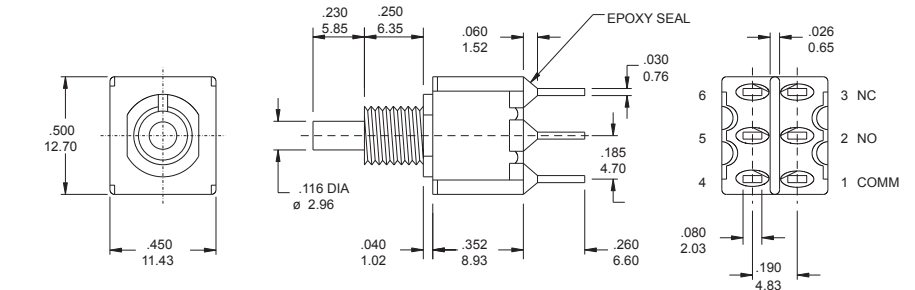

P8702-BR-E

DPDT



Model No.	Switching position	
P8702-A4	on	Mom
Term. Comm.	1-3 4-6	1-2 4-5

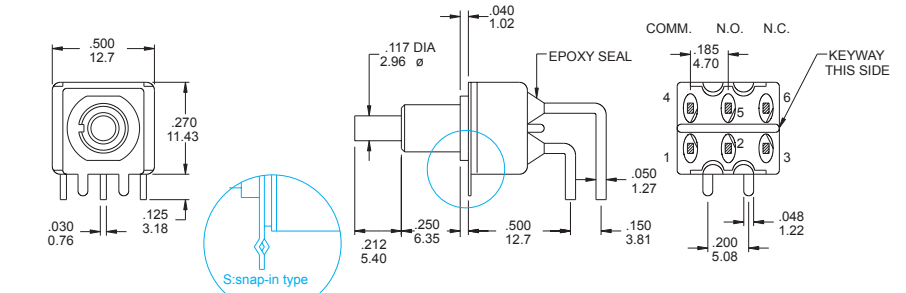

P8702-A4-R-E/ P8702-A4-R-E-S

DPDT



Model No.	Switching position	
P8702-A5	on	Mom
Term. Comm.	1-3 4-6	1-2 4-5

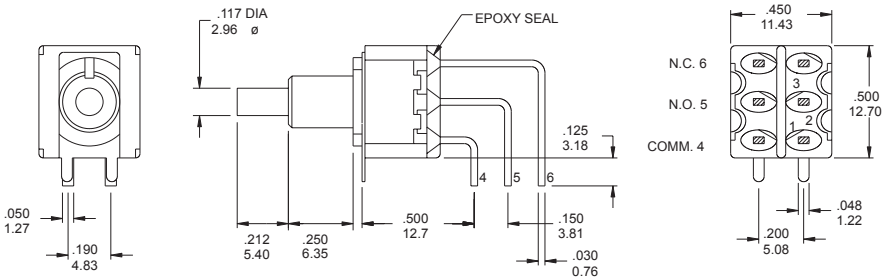

P8702-A5-R-E

D
2

Cap Option

Cap color Option

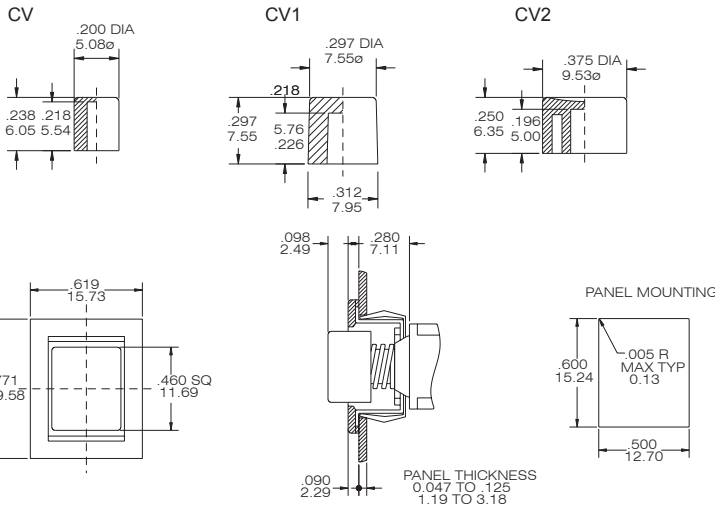

CAP & ACTUATOR OPTIONS	
1	White
2	Black(Std.)
3	Red
4	Orange
5	Yellow
6	Green
7	Blue
8	Brown
9	Gray

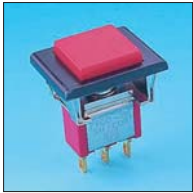

F22A

P870X-F22A-X-BR-E

Bushing Option

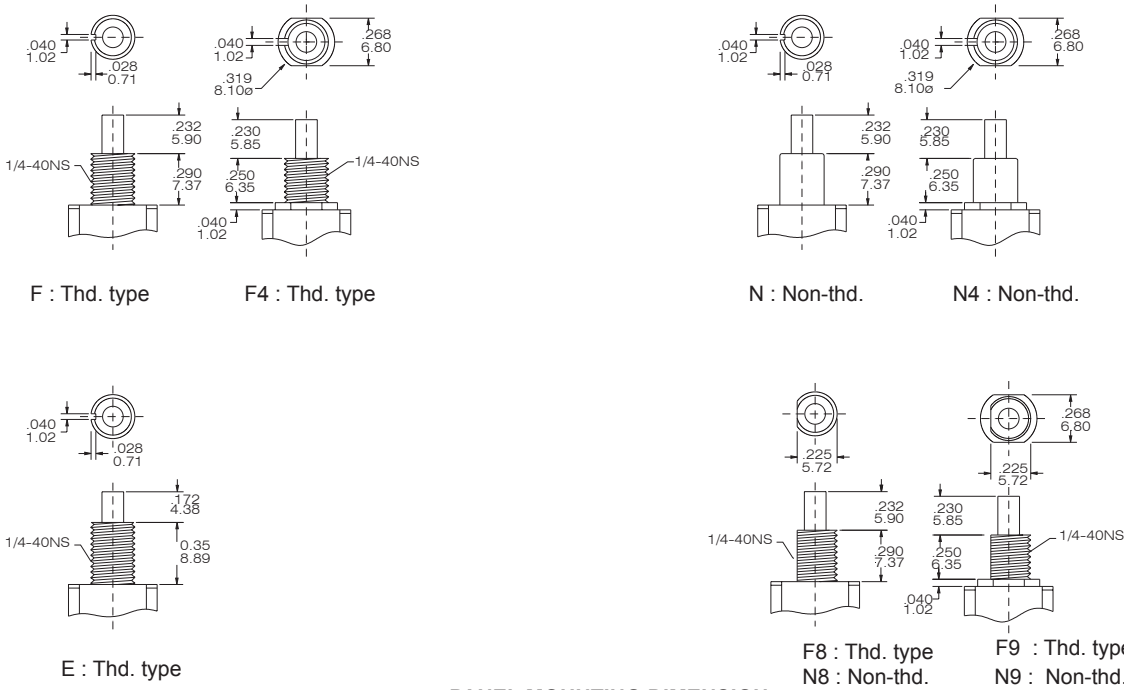

F : Thd. type

F4 : Thd. type

N : Non-thd.

N4 : Non-thd.

E : Thd. type

F8 : Thd. type
N8 : Non-thd.

F9 : Thd. type
N9 : Non-thd.

PANEL MOUNTING DIMENSION

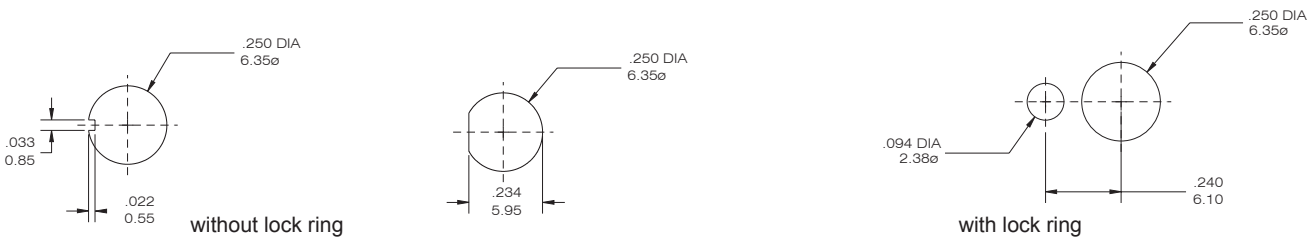

without lock ring

with lock ring

TERMINAL OPTION (ONLY FOR THE STRAGHT TYPE)

TERMINAL SEAL OPTION

B STD

C PRINTED CIRCUIT

D QUICK CONNECT

E TERMINAL SEAL

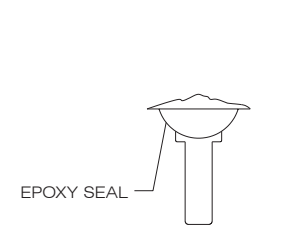
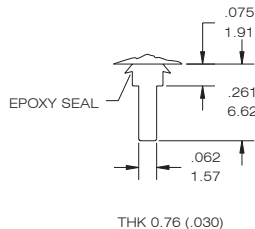
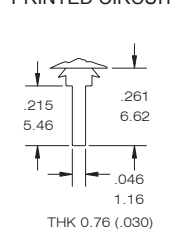
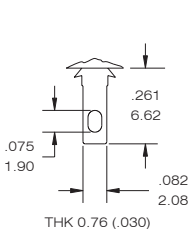

CONTACT MATERIAL OPTIONS

CODE	CONTACT MATERIAL	TERMINAL MATERIAL	RATING
Q	Silver plated	Silver plated	1A @ 120V AC or 28 V DC;
R	Gold plated over nickel plated	Gold plated over nickel plated	0.4 VA MAX @ 20V AC or DC MAX
G	Gold plated over silver plated	Gold plated over silver plated	0.4 VA MAX @ 20 V AC or DC MAX or 1 A @ 120V AC or 28 V DC;

VERTICAL SUPPORT BRACKET OPTION

(only apply the straight type terminal-Please modify the terminal option is "c" code)

S20/V20



SPDT

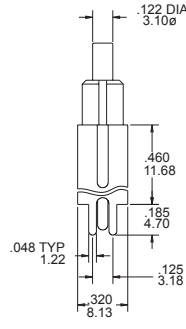
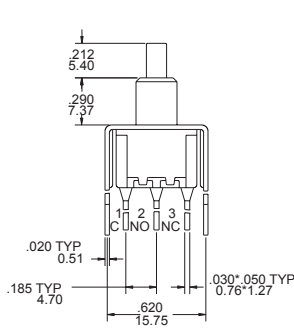

P.C. MOUNTING

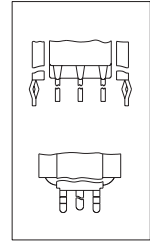
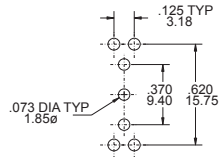

SNAP-IN V 20

P8701-CR-S20-E

S20/V20



DPDT

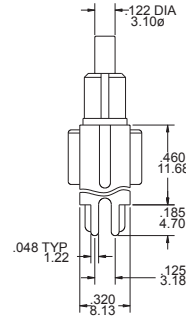
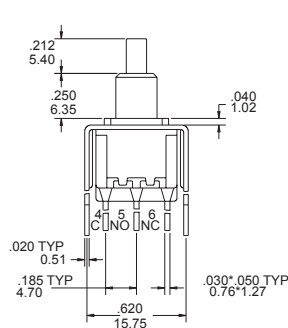

P.C. MOUNTING

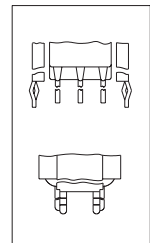
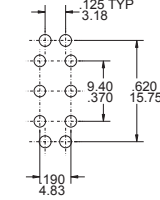

SNAP-IN V 20

P8702-CR-S20-E

The hardware of T80-P pushbutton switches

NUT

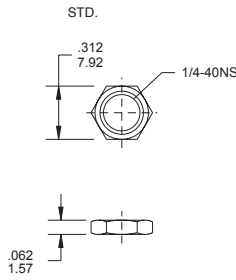

DRESS NUT

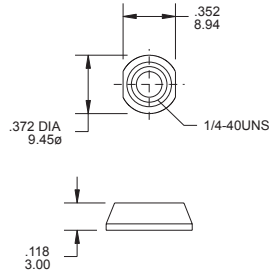

LOCK WASHER

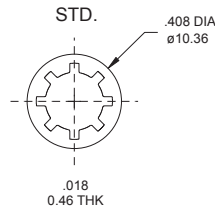

LOCKING RING

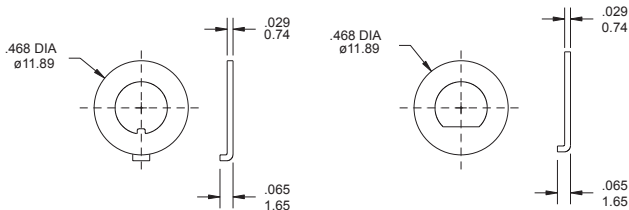

DRESS NUT & CAP

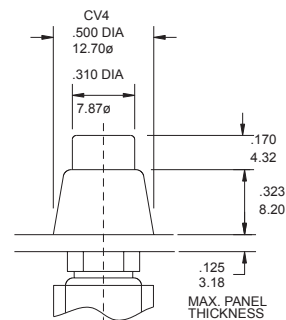

To order dress nut only.

The P.C.B mounting Dimension

P8701-A4

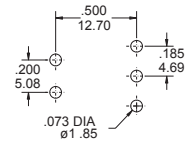

P8702-A4

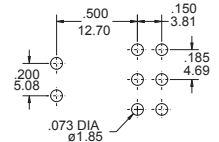

P8701-A5

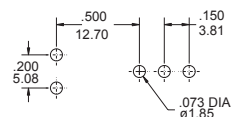

P8702-A5

